



TRAILER LIBERTY

Trailer-Liberty is a brand of the TRKW Automotive Technology group specializing in vehicle conversion.

Located in the outskirts of Lisbon, Portugal, Trailer-Liberty's mission is to manufacture the highest quality and most reliable Teardrops in the market.

During the development of the Teardrop Off Road Hicker, its designer and developer emphasized aesthetics, robustness, reliability, and the quality of materials used from the early stages of 3D modeling.

Our policy of continuous quality improvement allows us to stay at the forefront of technology and design. We extend this policy to all our customers, suppliers, and industrial partners.

Everything in this Teardrop has been designed to satisfy you and provide memorable moments on board, thanks to its aesthetics, modularity, ergonomics, comfort, and, of course, its robustness.

Whether you are a fan of extended weekends or trekking through breathtaking landscapes in complete autonomy, you will find the perfect Teardrop in our Hicker, Hicker One, and Hicker One+ models.

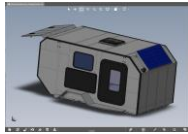
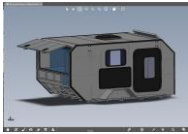

MADE IN PORTUGAL

HICKER ONE+



LAYOUT

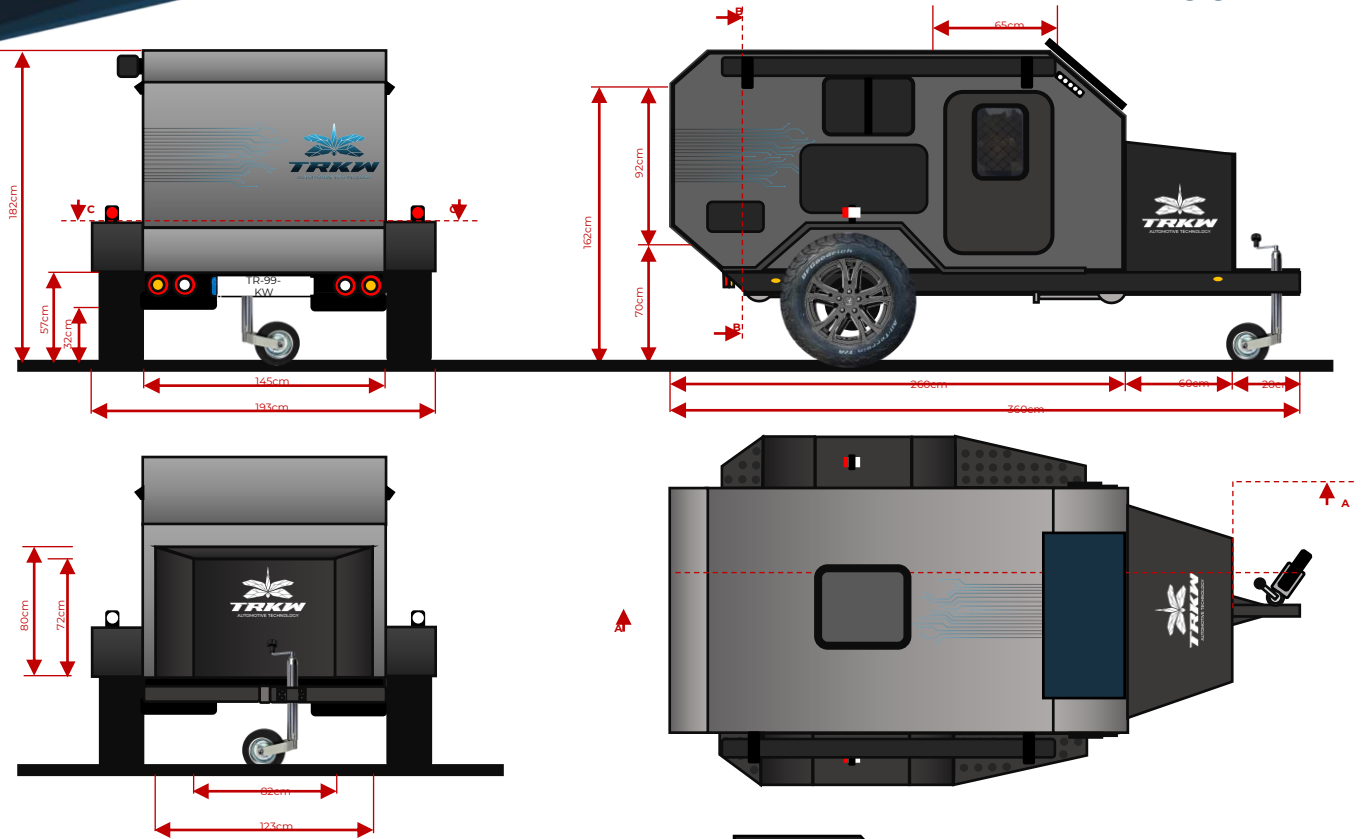

In the sleeping area, you will find a 140x200cm bed, powerful LED lighting and an adjustable LED strip in color and intensity. The sleeping cell is equipped with storage in the high position, independent heating (diesel). Under the bed is a large storage space accessible from both sides with more than 250 liters in total.

The **HICKER One+** is equipped with 12V-USB sockets as well as 220V sockets. A kitchen equipped with everything you need (water, gas hob, 46-litre fridge, storage, etc.) is located at the back with access from the outside.

A picnic shelf and a 190cm awning equip the right side. A 110Ah battery, a 5000W 220V power converter, charging by solar panel, by 220V network and by the vehicle, as well as a tank of 46 liters of clean water will allow you to leave for several days in complete autonomy.

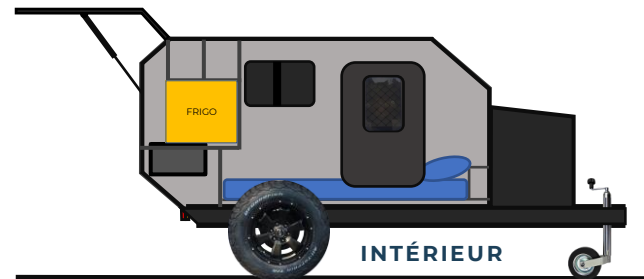

INTÉRIEUR



FRAME

- Steel frame with Polyurethane finish (Line-X / Raptor)
 - Al-KO axle 1300kg
 - 17" 5x112 rims
 - Full LED lights
 - 7 or 13 pin connector
 - Wheel chocks (2 units)
 - Cell in aluminum structure with Armaflex insulation and interior / exterior aluminum finish.
 - Weight in Full version of approximately 620/650Kg (in the process of finalizing series development)
 - Clearance lights
 - Mudguard / Aluminum steps
- Homologation with CoC in progress (expected to obtain September / October 2023).
 - Predicted start of production for the series November / December 2023.

Configuration of **HICKER ONE** with the additional equipment below

Cell (exterior)

- 2 doors with mosquito net that can be locked from the outside and from the inside (one per side)
- 2 sliding windows with mosquito net and curtain obscuring the interior (one per side)
- A tablet on the right side
- Side lighting (right and left)
- 1 Skydom on top
- Support for gallery or roof tent
- Thule awning 190 black

Front Box

- 110Ah slow discharge battery
- Charging by 220V network cable
- Charging by 150 W solar panel
- Inverter 220V pure Sinus 5000W
- 2kg ABC fire extinguisher

Cell (interior)

- Mattress 200 X 140
- Ambient LED lighting 12V
- USB socket (4 units)
- 220V socket (2 units)
- Bluetooth speakers
- Heating vent (autonomous diesel heating Kw)

Kitchen area

- Fridge 46 liters 220V



Technical area under kitchen

- ((Location of 5kw diesel heater for cell))
- On the outer right side: Hand shower

OPTIONS

- Hot water
- 200 Ah Lithium battery
- Bluetooth reversing camera with screen in the vehicle
- 10000W converter
- Desilting plate
- Interior reading lamp
- Reading lamp in the kitchen

